

# INSTALLATION DETAILS (Recommendations only)

## Concrete footings, 25mPa:

- Two 550x300x300mm minimum strip footing size
  - Bolt down to footings with 4x M12x75mm Dynabolts or similar
  - For extended leg option, set furniture into footings
- or

## Concrete slab, 25mPa:

- One 1900x550x100mm (minimum) thick slab recommended

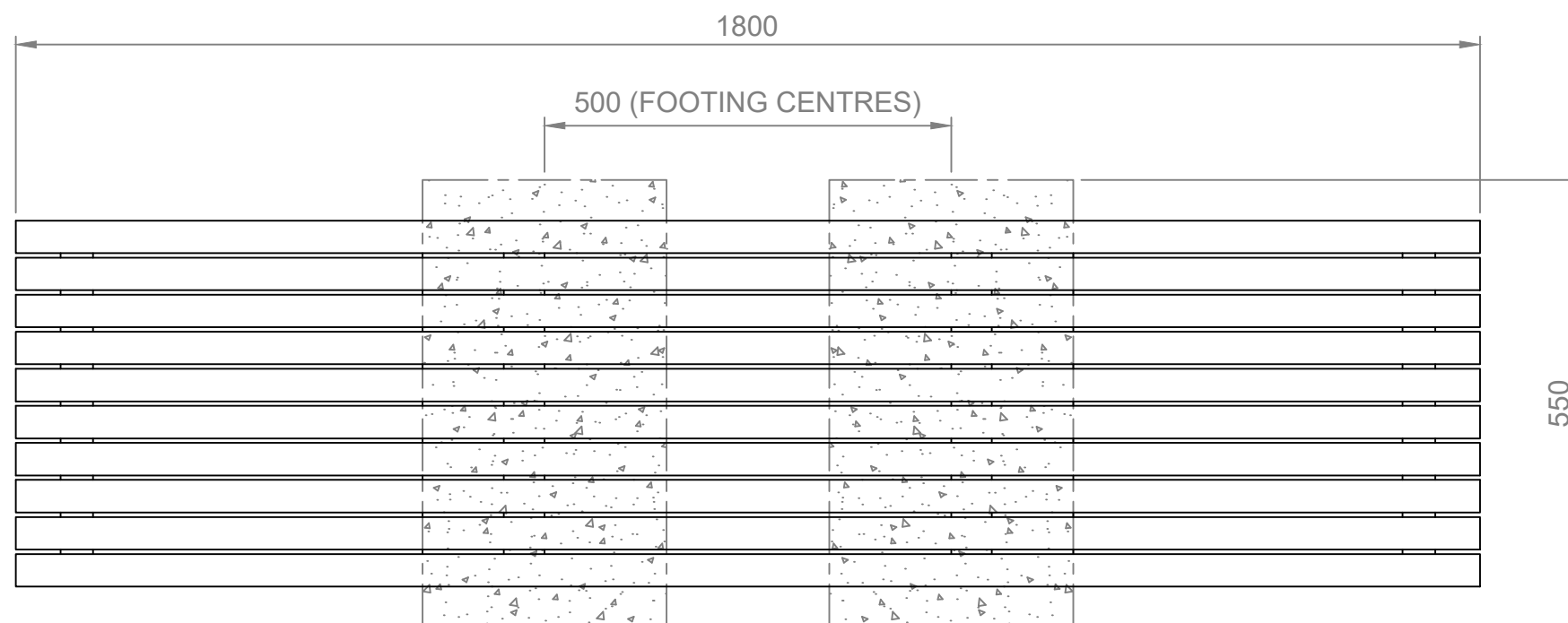

Top view

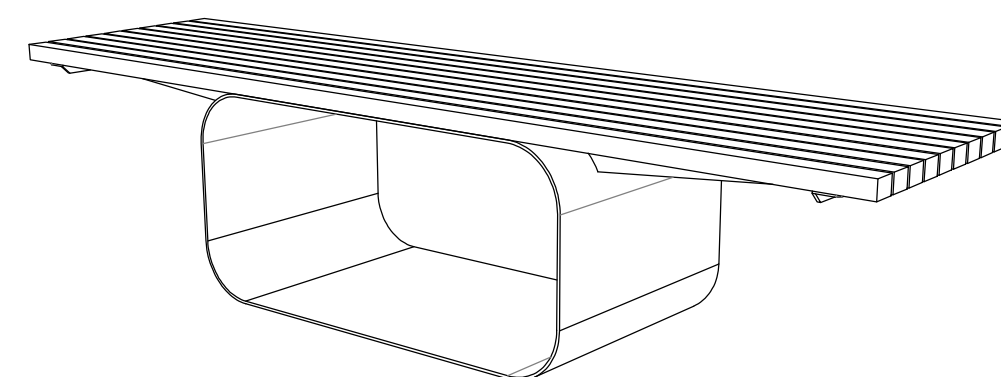

Perspective view

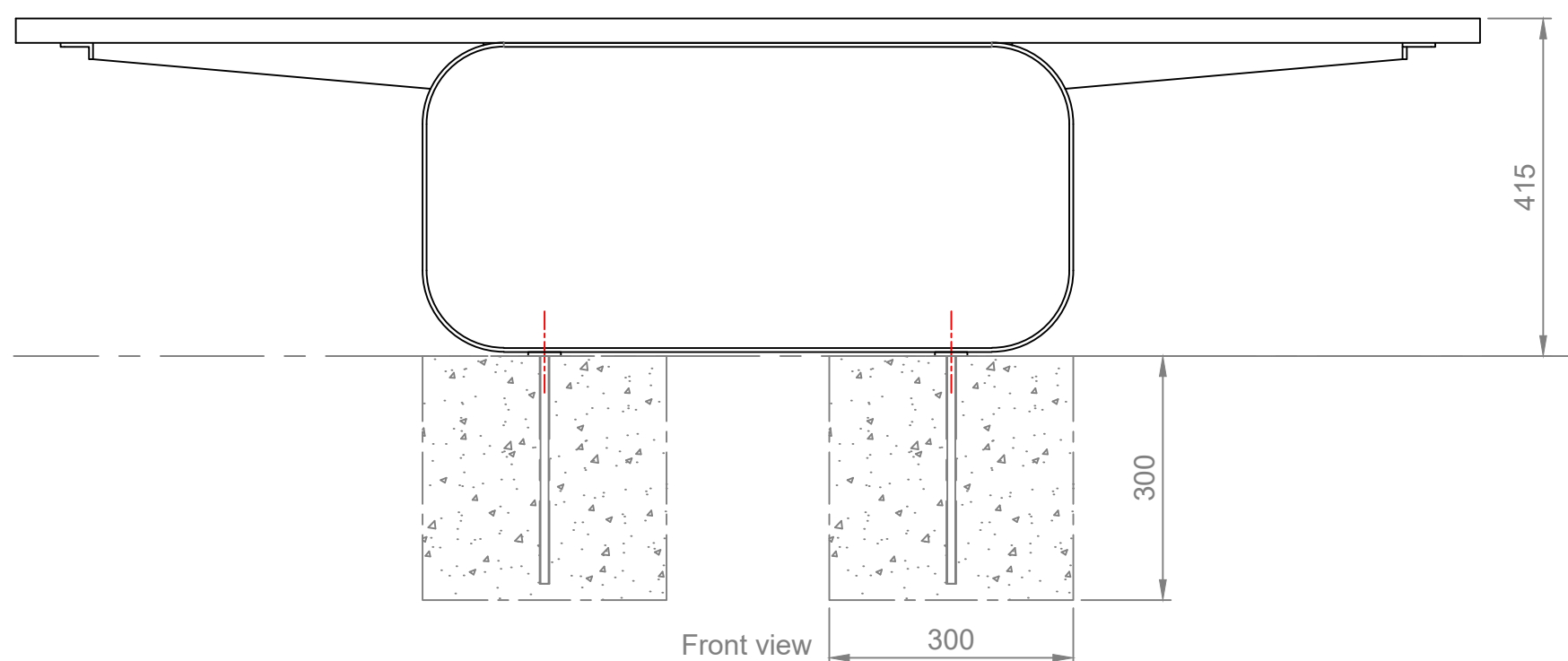

Front view

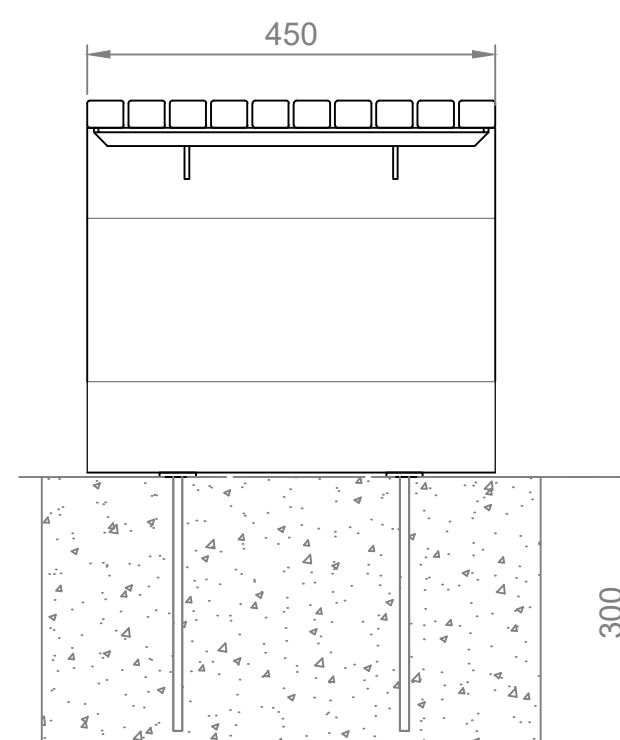

Right view



Commercial Systems Australia Pty. Ltd.

42 Orchard St, Kilsyth South, VIC

phone: (03) 9723 4111

fax: (03) 9723 3494

email: design@commercialsystems.com.au

Model Code: TM4631

Model Description: Loop Bench

**Drawing: CS2743**

Sheet Number: 1

Sheet Description: Product overview

Drawn By: K.Sohanpal

Date Drawn: 21.04.2016

Revision Number: 0

SCALE 1:1

ALL DIMENSIONS IN MILLIMETERS  
UNLESS OTHERWISE STATED  
ALL PARTS CENTRED UNLESS SPECIFIED

TOLERANCES

X +/- 1mm

X.X +/- 0.5mm

X.XX +/- 0.05mm